



Architectural and Landscape RGB LED Spot Light



LED Wave Length

- R =620-630 nm
- G =520-530 nm
- B =460-470 nm

Optics



FB08



30°

Outer Dimensions Unit:mm

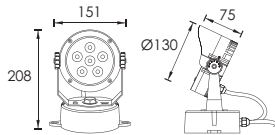

Material specifications

Housing	12" Die-casting dark grey powder coated aluminum. T=60-80µm. Adhesion of ISO class 1/ASTM class 4B
lens	All-in-one optical lens, efficiency ≥85%
Light Window	Tempered glass, T=3mm
Cable gland	IP-68 PG-9 PVC
Gasket	Tooling shaped seal
Bracket	Steel aluminum
Power Cable	H05RN-F 4X0.75mm² L=2.0m

Housing color Option

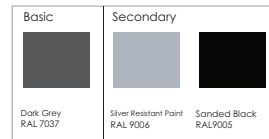

Item	Light source	Lens	The manufacturer selected lens degree(°)B1/2	Input voltage(V)	Typical operating current(mA)	Typical consumption(W)	Typical luminance(lm)	IK rate
FB3BDM0619	6 x 3W RGB 3in1 Full color	FB08	30°	24V DC	R = 350 G = 350 B = 350	25.0	473	08

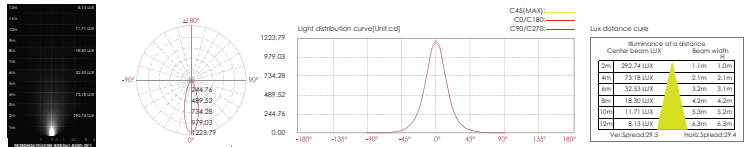

352



Architectural and Landscape RGB LED Spot Light



LED Wave Length

- R =620-630 nm
- G =520-530 nm
- B =460-470 nm

Optics



FB08



30°

Outer Dimensions Unit:mm

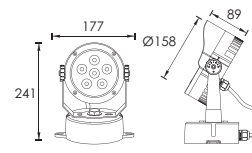

Material specifications

Housing	12" Die-casting dark grey powder coated aluminum. T=60-80µm. Adhesion of ISO class 1/ASTM class 4B
lens	All-in-one optical lens, efficiency ≥85%
Light Window	Tempered glass, T=3mm
Cable gland	IP-68 PG-9 PVC
Gasket	Tooling shaped seal
Bracket	Steel aluminum
Power Cable	H05RN-F 4X0.75mm² L=2.0m

Housing color Option



Item	Light source	Lens	The manufacturer selected lens degree(°)B1/2	Input voltage(V)	Typical operating current(mA)	Typical consumption(W)	Typical luminance(lm)	IK rate
FB3CBM0618	6 x 2W RGB 3in1 Full color	FB08	30°	24V DC	R = 200 G = 250 B = 250	16.5	300	08

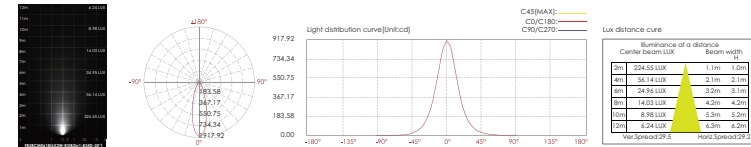

353